

THIS COPY HAS BEEN MADE BY OR WITH THE AUTHORITY OF RYEDALE DISTRICT COUNCIL PURSUANT TO SECTION 42 OF THE COPYRIGHT DESIGNS AND PATENTS ACT 1988. UNLESS THAT ACT PROVIDES A RELEVANT EXCEPTION TO COPYRIGHT, THE COPY MUST NOT BE COPIED WITHOUT THE PRIOR PERMISSION OF THE COPYRIGHT OWNER.

# Gound Floor and Site Plan

Scale 1:200 @ A1

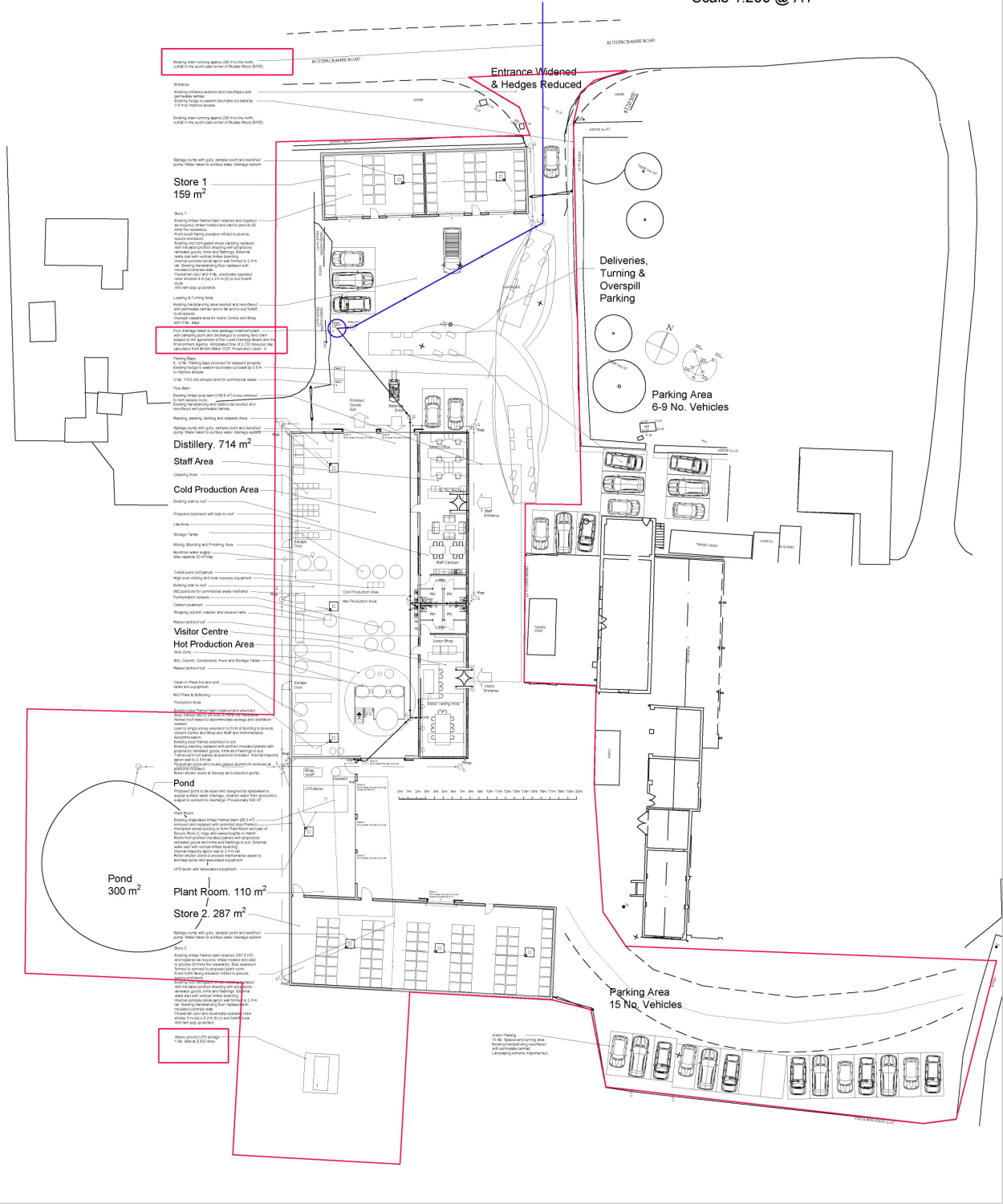

Client:	Elms Farm Distillery, Ltd
Address:	33 Park Farm, Leeds, LS1 2RY
Project:	Visitor Distillery Feasibility
Design:	Ground Floor and Site Plan
Issue:	01
Date:	August 2020
Author:	SD
Checker:	CM
Project No:	19/001
Drawing No:	01
Scale:	1:200
Drawn by:	GMW/455-08-01

**The Planning & Design Associates**  
 195, The Quadrant, Leeds LS1 2JY  
 Tel: 0113 275 1111  
 Fax: 0113 275 1112  
 Email: [info@pda.co.uk](mailto:info@pda.co.uk)  
 Website: [www.pda.co.uk](http://www.pda.co.uk)

Plan C20/01/2021 LPS Size subject to change now  
 Rev B 15/2020 LPS issue enclosed  
 Rev A 15/2020 Rev changes from Rev B to LPS

**NOTES**

1. This drawing is a site plan for the proposed visitor distillery facility at Elms Farm, Leeds LS1 2RY. It shows the layout of the building, parking areas, and other site features.
2. The building footprint is shown in red. The parking areas are shown in blue.
3. The site is bounded by Wittoncliffe Road to the north and Buttercliffe Road to the east.
4. The entrance to the site is located on Buttercliffe Road. The entrance has been widened and the hedges reduced.
5. The site includes a large pond (300 m²) located to the west of the building.
6. The site is divided into several areas, including a distillery (714 m²), a staff area, a cold production area, a visitor centre, a hot production area, a plant room (110 m²), and two stores (159 m² and 287 m²).
7. The site also includes a delivery and turning/overspill parking area, and two other parking areas (6-9 vehicles and 15 vehicles).
8. The site plan is shown at a scale of 1:200.
9. The drawing was prepared by The Planning & Design Associates, Leeds.
10. The drawing is a site plan for the proposed visitor distillery facility at Elms Farm, Leeds LS1 2RY.
11. The site is bounded by Wittoncliffe Road to the north and Buttercliffe Road to the east.
12. The entrance to the site is located on Buttercliffe Road. The entrance has been widened and the hedges reduced.
13. The site includes a large pond (300 m²) located to the west of the building.
14. The site is divided into several areas, including a distillery (714 m²), a staff area, a cold production area, a visitor centre, a hot production area, a plant room (110 m²), and two stores (159 m² and 287 m²).
15. The site also includes a delivery and turning/overspill parking area, and two other parking areas (6-9 vehicles and 15 vehicles).
16. The site plan is shown at a scale of 1:200.
17. The drawing was prepared by The Planning & Design Associates, Leeds.

**PLANNING PERMISSIONS**

The proposed development is subject to the following planning permissions:

- 1. Planning permission for the proposed visitor distillery facility at Elms Farm, Leeds LS1 2RY, granted on 15/08/2020 under Planning Permission Ref: C20/01/2021 LPS.
- 2. Planning permission for the proposed visitor distillery facility at Elms Farm, Leeds LS1 2RY, granted on 15/08/2020 under Planning Permission Ref: C20/01/2021 LPS.
- 3. Planning permission for the proposed visitor distillery facility at Elms Farm, Leeds LS1 2RY, granted on 15/08/2020 under Planning Permission Ref: C20/01/2021 LPS.